

FLUSHING ▶ 1.5" / 2.0" KAYLA CABLE OPERATED DUAL FLUSH OUTLET VALVE

Please ensure these instructions are followed carefully – if you are unsure about any aspect of the installation, please consult a qualified installer. In the event of any problem with the function of this equipment, please check installation before consulting your supplier.

WARNING: Do not use mole grips and do not overtighten plastic nuts.
Do not use a sealing compound as damage may occur to plastic components.

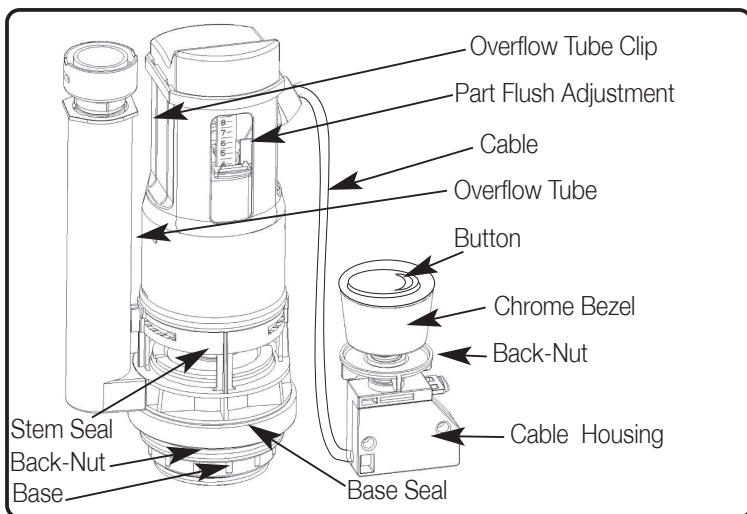

To adjust the full flush volume, raise/lower the full flush adjustment as shown; the lower the slide is set, the higher the flush volume will be.
Note: The flushing valve is preset to flush 6 litres (nominal) minimum volume, when the slide is in the lowest position.

3

To adjust the part flush volume, move slide up for less and down for more.

4

Place the base seal over threaded section and feed through bottom of cistern. Secure hand-tight plus half a turn using back-nut supplied (using a suitable spanner). Shown below are bolted and plated kit assemblies for close coupled WC pans and cisterns.

BOLTED KIT	PLATED KIT
<ul style="list-style-type: none"> Bolt Plastic Sleeve Plastic Washer Cistern Plastic Washer Metal Nut Pan Plastic Washer Metal Wing Nut 	<ul style="list-style-type: none"> Back-Nut Cistern Base Plate WC Pan Bolt Rubber Washer Metal Washer Finger Nut

1

Insert button through cistern lid and secure hand-tight using the bezel and back-nut provided. Then place the cistern lid onto the cistern.
If fitting the inlet valve to the left of the cistern, route the cable to the right so that the cable does not obstruct the float of the inlet valve. (Reverse for opposite hand feed.)

N.B. Style of cistern may vary from that shown.

5

For internal overflow, measure from base of cistern to waterline and add 20 to 50mm. Ensure that the top of the overflow is a minimum of 10mm below any aperture in the cistern (such as fixing holes).
To adjust overflow tube, slide the overflow tube clip as shown and raise/lower to suit your installation.
When height is set, slide the overflow tube clip back to secure.
Test overflow by making the inlet valve fail. If overflow cannot cope with all incoming water, turn the isolation valve (not supplied) to reduce water flow and try again.

2

Trouble Shooting

To clean the seal (if water is leaking into WC pan), unclip the button assembly and remove cistern lid. Twist the main body of the valve 1/8th turn anti-clockwise and remove, pull the stem seal off, clean with warm water, then re-fit the valve by re-inserting the 2 lugs and turn 1/8th clockwise and re-fit the cistern lid.

Re-check for leaks.

6

IMPORTANT – AV068 and DVA0100 FITTING PACKS ONLY

For 2" outlet hole use thick base seal washer

For 1 1/2" outlet hole use thin base seal washer

Code:	PM100KAY
Issue No.	02
Date:	10/03/2015

WIRQUIN LTD - Warmsworth Halt Industrial Estate - Warmsworth - Doncaster - DN4 9LS - UNITED KINGDOM
Sales / Aftersales: ☎ 0044 (0)844 412 2029 ✉ sales@wirquin.co.uk / aftersales@wirquin.co.uk
www.wirquin.co.uk

Macdee
wirquin
SANITARY EQUIPMENT SPECIALIST