

# Installation Illustration

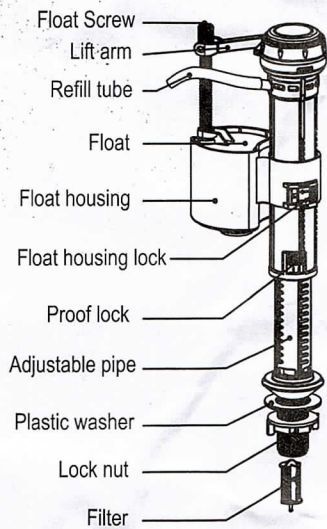

## Installation height adjustment

Purpose: Adjust the working height of filling valve, to fit for toilet tank size, so that filling valve working correct inside.

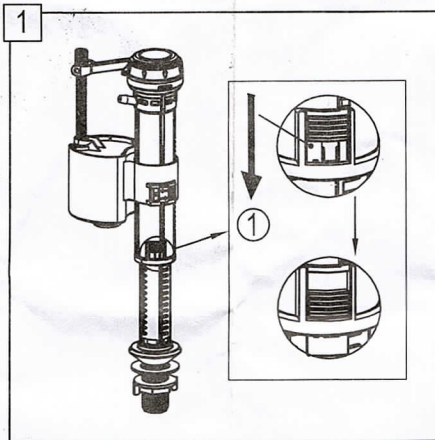

1. As showed on figure ①, push the proof lock down to the end, to release filling valve height to fixed position.

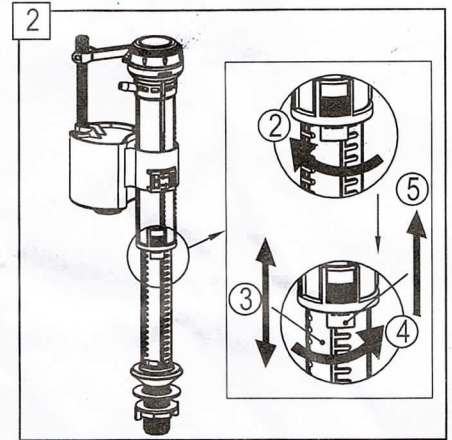

2. As showed on figure ②, turn the adjustable pipe clockwise to the end and lift it up or down as ③ to an appropriate height, then screw the adjustable pipe anticlockwise to the end as ④, push the proof lock up back as ⑤ to fix the adjustable pipe on appropriate position.

## Water level adjustment

Purpose: Adjust the float cup, to set up water working level, to get best flush result and save water at the same time.

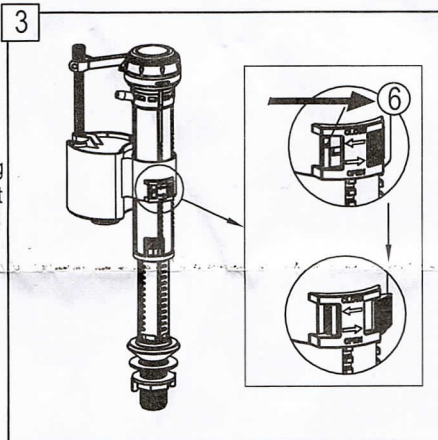

3. As showed on figure ③, put the float housing lock along OPEN direction.

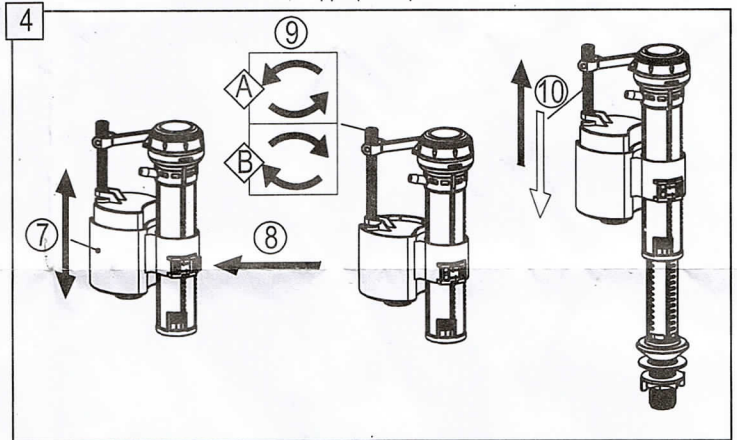

4. As showed on figure ④, move the float housing up or down along the filling valve body to an appropriate height and push float housing lock along to CLOSE direction as ⑧ to lock floating housing on the suitable position. As ⑨, turn the float screw as per A / B indicated, to make the float sitting in float housing freely. Then check if it works correct with: As ⑩, lift up the lift arm, the float top level should be 10-15mm higher than the float housing top. Release the lift arm, the float should come down freely to sit in float housing.

## Fill valve installation

Purpose: Install filling valve into toilet tank correctly, be sure it is fixed without leaking, and clean for maintain after long term using.

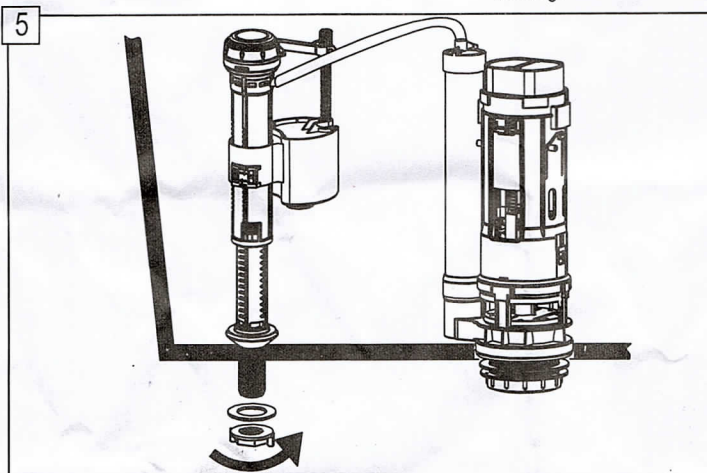

5. As showed above, release the lock nut and plastic washer, put filling valve shank down through tank filling hole, be sure the filling valve body stand straight. Make sure the float do not contact to any other parts in the tank.

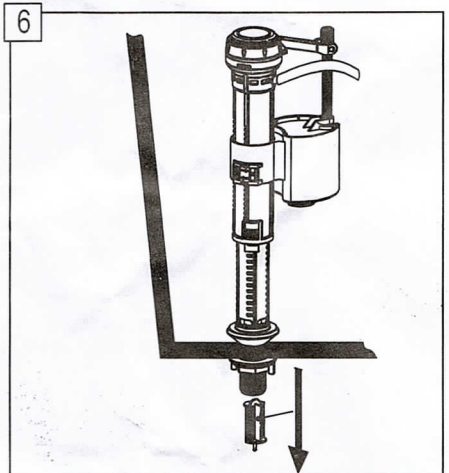

6. After using for a long while, if you find water filling takes longer time, disconnect the filling valve with water supplying pipe, use pincers to take filter out from filling valve shank, as showed above. Clean the filter, insert it back, connect with water supplying, then the water filling speed will get normal again.